

May 2025

Beeston Street at Macquarie Street, Teneriffe Local Access Network Improvements

Start of construction

What works are coming up?

Works to improve safety and accessibility on Beeston Street at Macquarie Street in Teneriffe will start soon.

When will this work take place?

Start	Late May 2025
Finish	Early July 2025, weather and site conditions permitting
Time and day	7am to 5pm, Monday to Friday

What does this work include?

As part of these works, we will:

- install a pedestrian refuge island on Beeston Street at Macquarie Street
- build out the kerb and upgrade kerb ramps on both sides of Beeston Street, and the western side of the existing pedestrian refuge crossing on Macquarie Street
- complete minor footpath improvements
- paint associated line marking, including yellow 'No Stopping' lines where on-street parking will not be permitted.

Bus stop and loading zone changes

Bus stop 14 (Macquarie Street at Mercantile Place) will be relocated approximately 12 metres north on Macquarie Street to ensure safe sightlines for all road users at the intersection of Beeston and Macquarie streets.

The loading zone space adjoining the bus stop will be shortened and will accommodate one vehicle. To ensure a balanced distribution of loading zone parking in this area, we will:

- convert 2 regular parking spaces to loading zone spaces outside Woolstore Ansonia Apartments, closest to Beeston Street
- reduce the existing loading zone between Woolstore Saratoga and Ansonia Apartments to 4 loading zone spaces and create 2 new regular parking spaces.

Why is this work happening?

Improvements as part of this project will:

- provide safer and more accessible pedestrian connections
- reduce corner cutting and encourage slower and safer vehicle movements
- improve visibility for all road users.

This project is part of our Local Access Network Improvements program, which focuses on minor upgrades to ensure our suburbs are safe and accessible for people walking, riding and driving.

What does this mean for me?

If you live in or are travelling through the area, you may notice:

- increased noise, dust, vibration and vehicles
- changed traffic conditions, including footpath and lane closures, and reduced speed limits
- traffic controllers and signage onsite.

On-street parking within the work area will not be available during construction.

We would like to thank the community for their patience while these important works are undertaken.

Contact us

To find out more about this project, you can contact us by:

3178 5413 (business hours)



3403 8888 (24 hours)



cityprojects@brisbane.qld.gov.au



Visit brisbane.qld.gov.au and search 'Beeston Street at Macquarie Street, Teneriffe Local Access Network Improvements'

LOCAL ACCESS NETWORK IMPROVEMENTS

BEESTON STREET AT MACQUARIE STREET, TENERIFFE

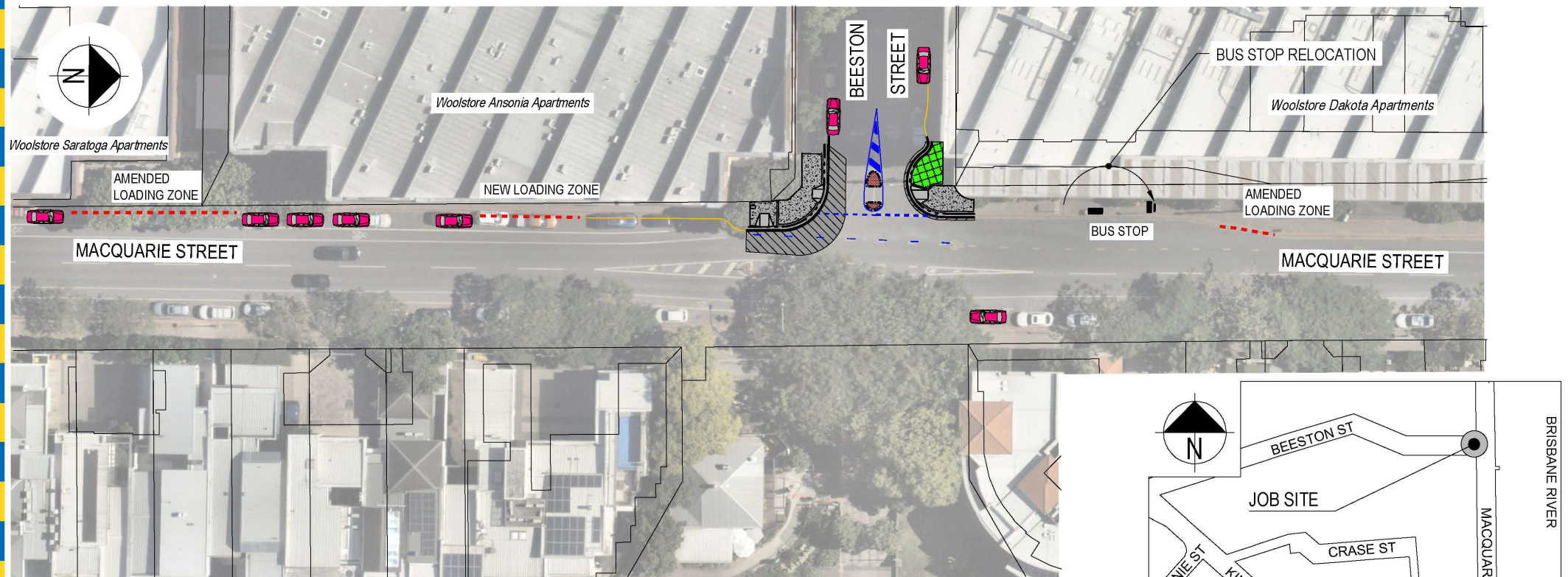

LEGEND:

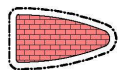

150mm HIGH STENCILLED
CONCRETE ISLAND



INDICATES PARKING

INDICATES LOADING
ZONE

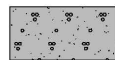

AREA TO BE CONCRETE



INDICATES NO STOPPING AREAS



YELLOW NO STOPPING AT
INTERSECTIONS - 10m MINIMUM
CLEARANCE RULE.
NOTE: QLD ROAD RULES SEC.170 (4)
REQUIRES NO STOPPING WITHIN
10m OF INTERSECTION.



KERB RAMP



PAINTED LINES (DRIVE OVER
TO ACCESS PROPERTIES)



AREA TO BE PAVEMENT



AREA TO BE LANDSCAPED

LOCALITY



Dedicated to a better Brisbane

SECURITY LABEL: FOR PUBLIC USE ONLY

DATA INFORMATION
Brisbane City Council (unless stated below)
Copyright © 2010 Department of Natural Resources and Mines
Copyright © 2002 AAMatch
StreetView, digital aerial data © 2010 Pavey Data Inc.
2028 Neumap © 2020 Neumap Pty Limited
2012, 2016 Aerial Imagery © 2011 AAM Pty Limited
2009 Aerial Imagery © 2009 AAMatch Pty Limited
2003 Aerial Imagery © 2003 Fugro Spatial Solutions
2005 Aerial Imagery © 2005 GUSCO
2014 Extracted from map © 2003 Mapbox Publishers

DATA DISCLAIMER
In consideration of Council, and the copyright owners listed above, permitting the use of this data, you acknowledge and agree that Council, and the copyright owners, give no warranty in relation to the data (including accuracy, reliability, completeness, currency or suitability) or of accepting liability (including without limitation, liability in negligence) for any loss, damage or costs (including consequential loss/damage, relating to use of this data.

For more information about this project, please call the project team on 07 3178 5413 or email cityprojects@brisbane.qld.gov.au.