

May 2025

Swan Terrace, Windsor Local Area Traffic Management

Start of construction

What works are coming up?

We are pleased to advise works on Swan Terrace in Windsor as part of our Local Area Traffic Management (LATM) project will start soon.

Council's LATM program delivers improvements across Brisbane's local road precincts and suburbs to ensure safer and slower roads.

When will this work take place?

Start	Early May 2025
Finish	Early June 2025, weather and site conditions permitting
Time and day	7pm to 5am, Sunday to Thursday

These works are required to be undertaken at night when traffic volumes are lowest, to ensure the safety of workers and road users, and to minimise disruption to the road network.

What does this work include?

As part of these works, we will be:

- painting a threshold treatment on Swan Terrace at Northey Street
- installing a pedestrian splitter island and painting a threshold treatment on Swan Terrace at Newmarket Road
- painting associated line marking, including yellow 'No Stopping' lines.

On-street parking will not be permitted where yellow 'No Stopping' lines are in place to ensure safe sightlines at crossing points and to ensure lanes are wide enough for traffic to safely pass.

Please see the project plan on the next page for more details.

Why is this work happening?

The improvements for Swan Terrace will:

- provide safer and more accessible pedestrian crossing points
- reduce corner cutting and encourage slower vehicle speeds
- increase sightlines and visibility.

These improvements are being delivered following community support in 2020 and our recent technical review of traffic data in the area.

What does this mean for me?

If you live in or are travelling through the area, you may notice:

- increased noise, dust, vibration and vehicles
- changed traffic conditions, including footpath and lane closures, and reduced speed limits
- traffic controllers and signage onsite.

On-street parking in the project area will not be available while construction is underway.

Council would like to thank you for your patience while these important works are undertaken.

Contact us

To find out more about this project, you can contact us by:

 **3178 5413** (business hours)
3403 8888 (24 hours)

 **cityprojects@brisbane.qld.gov.au**

 Visit brisbane.qld.gov.au and search 'Swan Terrace, Windsor Local Area Traffic Management'

LOCAL AREA TRAFFIC MANAGEMENT

SWAN TERRACE - WINDSOR

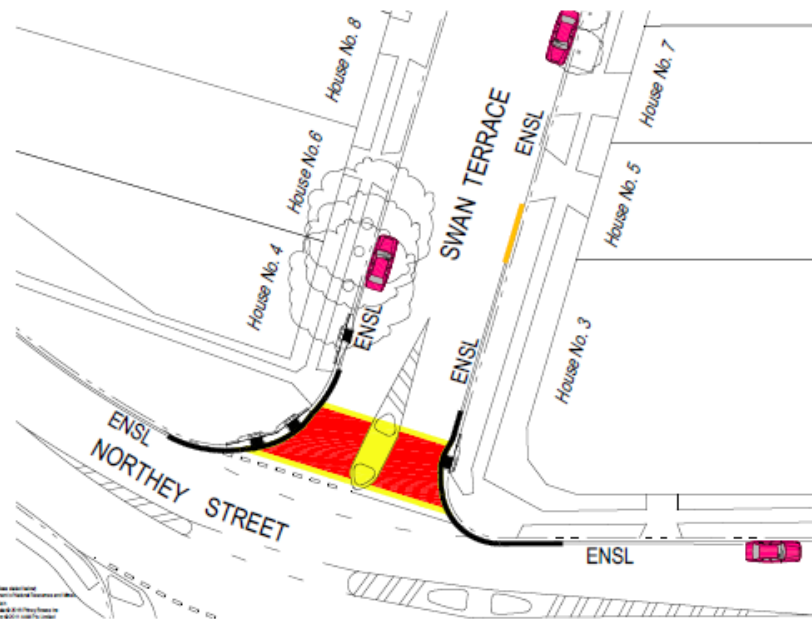
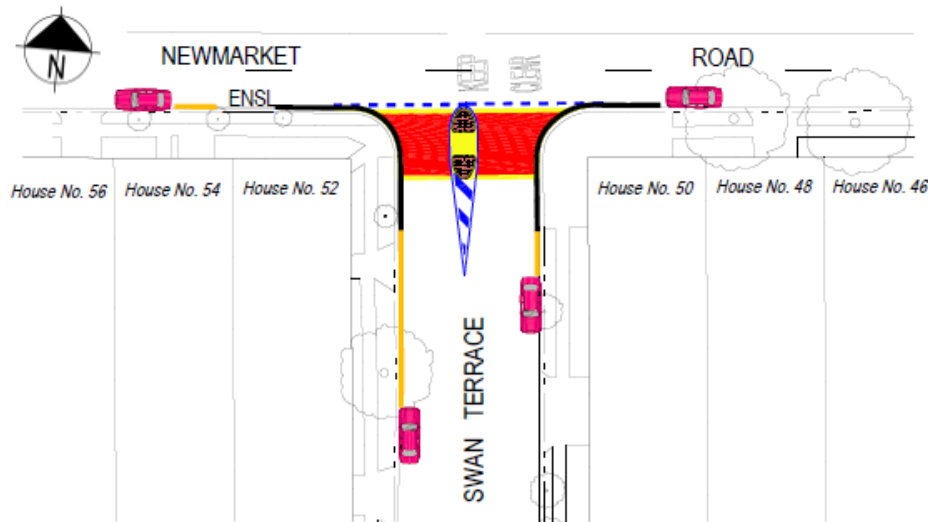

LEGEND:

-  EXISTING TREES
-  NEW COLOURED PAVEMENT TREATMENT - NO PATTERN
-  150mm HIGH STENCILLED CONCRETE ISLAND
-  PAINTED LINES (DRIVE OVER TO ACCESS PROPERTIES)
-  INDICATES PARKING
-  PROPOSED YELLOW NO STOPPING - (BASED ON SIGHT DISTANCE REQUIREMENTS)
-  ENSL EXISTING YELLOW NO STOPPING LINE
-  YELLOW NO STOPPING AT INTERSECTIONS - 10m MINIMUM CLEARANCE RULE

NOTE: QLD ROAD RULES SEC.170 (4) REQUIRES NO STOPPING WITHIN 10m OF INTERSECTION.

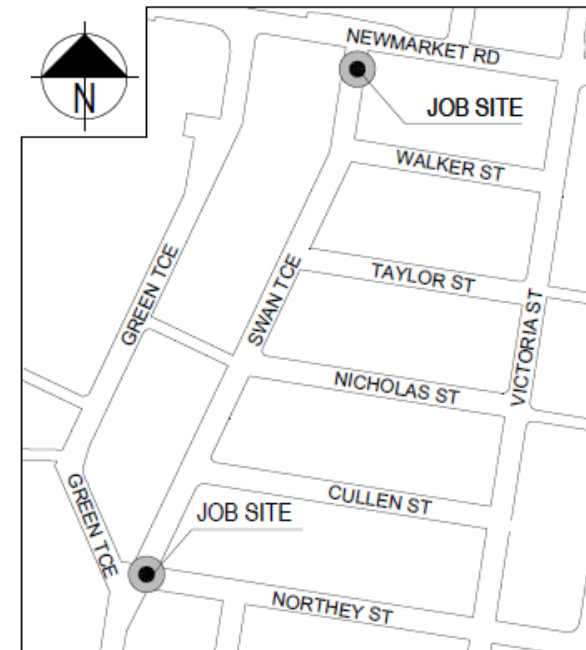

LOCATION

200507 / 401

Information for the public:
This document is a draft and is for informational purposes only. It is not to be used for legal or financial purposes.
The project team is not responsible for any errors or omissions in this document.
The project team is not responsible for any damage or loss resulting from the use of this document.
The project team is not responsible for any damage or loss resulting from the use of this document.

SECURITY LABEL: FOR PUBLIC USE ONLY



Dedicated to a better Brisbane